

47202 Skyline Drive
Chilliwack, BC V2R 0R4

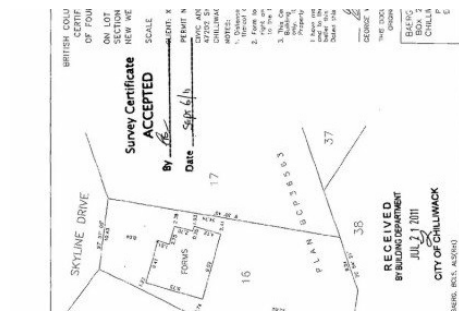

Powered by homes.theprogress.com

MLS# R3044063



\$959,000

4 Bedrooms | 3 Bathrooms | 3,078 Sqft

Wonderful 3 storey home on Promontory with amazing views of the valley and surrounding mountains! The main floor boasts an open concept floorplan with a bright kitchen featuring stainless steel appliances, large pantry, dining room, living room, and fabulous media room complete with a wet bar - perfect for entertaining! Upstairs offers 4 bedrooms with the large primary bedroom featuring a private deck with sweeping views as well as an awesome ensuite with a jetted tub, separate shower, and double sinks. This home is ideally located within walking distance to Jinkerson Park - great for dog walkers, families, and enjoying the amazing trails on Promontory. The backyard is deceptively large and you could transform the sloped terrain into a private oasis. Priced well below 2025 assessed value!



Royal LePage Wheeler Cheam Realty

Phone: (604) 792-0077

Royal LePage

Office: (604) 792-0077

For full listing details, please scan:

